

TECHNOLOGY IN MOTION

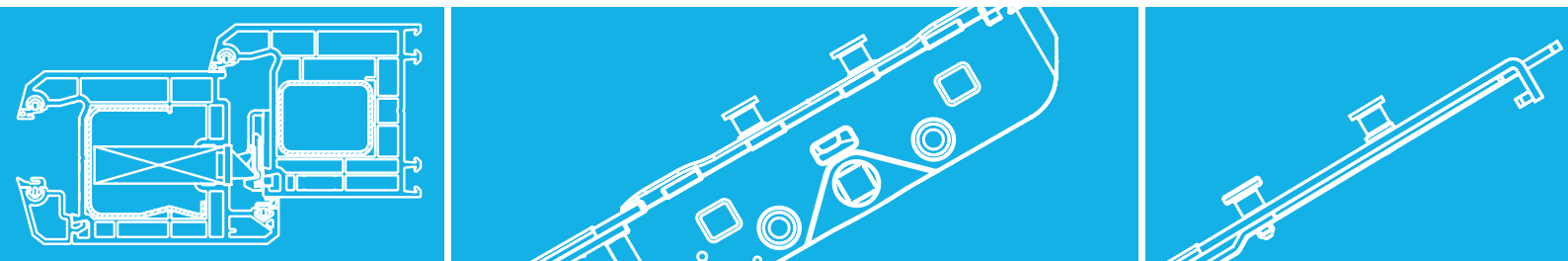

MACO
ESPAGS
ESPAGNOLETTES



M-SPAG Telescopic Shootbolt Espagnolette
PVC, Timber, Aluminium & Composite



Overview sizes M-SPAG

Four telescopic and one croppable shootbolt espagnolette ranging from 320mm to 1500mm

① Size 4 · 1200–1500 mm

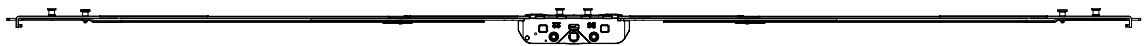

② Size 3 · 900–1200 mm



③ Size 2 · 700–900 mm

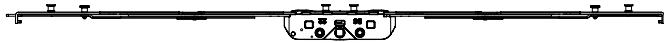

④ Size 1 · 600–700 mm



⑤ Size 0 · 320–600 mm

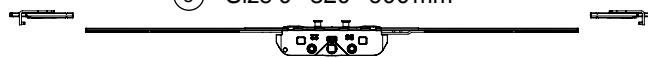



Routing details M-SPAG

① Sash Preparation:

Machine a 12 mm wide 120 mm long slot centrally to the eurogroove with a 12 mm DIA. cutter

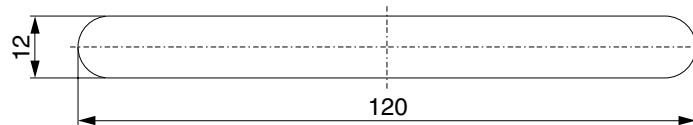

Routing Length = 120 mm

Routing Width = 12 mm

② Handle Hole Drilling:

Drill the handle holes to match the appropriate lockcase backset.

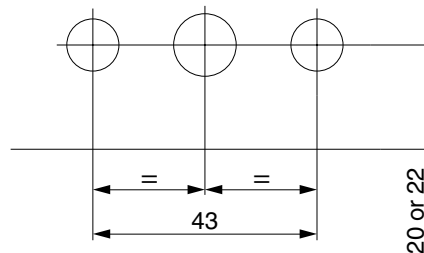

③ Backset Selection:

The lockcase depth is 7.2 mm more than the backset the rear of lockcase should not interfere with the reinforcing or the back wall of the profile.

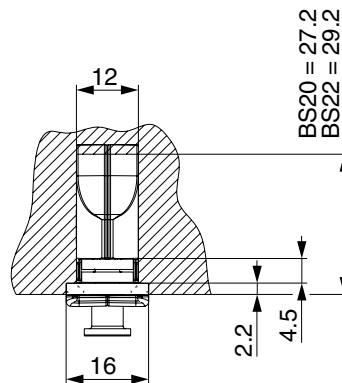

Cam compression adjustments specification requirements

① Mushroom Cams

Mushroom cams are used on all MACO espagnolette and shootbolt locking systems they are designed to give both security and weather compression to the window.

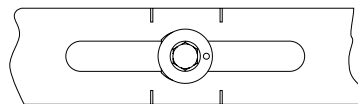

Standard Compression

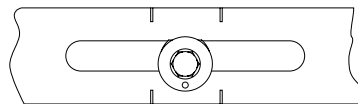

Reduced Compression -0,75 mm

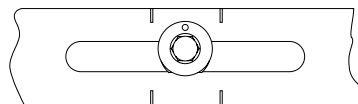

Increased Compression +0,75 mm

② Mushroom Cam Height

MACO produces 2 different mushroom cam heights, 7,7, 9,0. The different heights ensure that the window operates without clashing on the frame.

③ Mushroom Cam Adjustment

MACO mushroom cams are adjustable with a 4 mm allen key to ensure the smooth operation of the window through the changing of gasket compression. MACO Mushroom cams give +/- 0,75 mm compression adjustment.

Installing the M-Spag Telescopic shootbolt espagnolette into the sash

- ① Set the shootbolt throw on the shootbolt end pieces (10 or 13 mm) to the necessary size for your profile system.



- ② Locate M-SPAG into the eurogroove.
Note: The handing is shown on the side of the lockcase, with the handle holes on the sash facing upwards install the M-SPAG with the corresponding handing facing upwards.

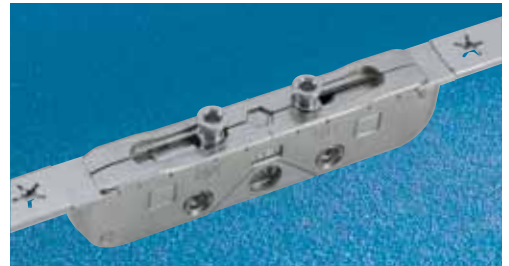

- ③ Push both end pieces fully into the corners of the eurogroove.



- ④ Screw M-SPAG into the sash.
Note: It is recommended that the screw order is as follows:

- ① either side of the lockcase.
- ② the shootbolt end screws.
- ③ all other screw fixings.



- ⑤ Remove pull-out pin and operate window





Installing the M-Spag espagnolette Gr.0 into the sash

- ① Set the shootbolt throw on the shootbolt end pieces (10 or 13 mm) to the necessary size for your profile system.



- ② Locate shootbolt end pieces into the eurogroove

- ③ Locate M-SPAG Gr.0 drive gear into the sash, mark the faceplate to size in relation to the shootbolt end pieces and cut to size



or

Cut the M-SPAG Gr.0 drive gear to size by using the following formula

$$SRW \div 2 - 45mm \text{ per side}$$

- ④ Locate M-SPAG Gr.0 drive gear into the sash. Note: the handing is shown on the side of the lockcase, with the handle holes on the sash facing upwards install the M-SPAG Gr.0 with the corresponding handing facing upwards



- ⑤ Slide the connection covers down the faceplate of the Gr.0 drive gear until they locate over the shootbolt end pieces



- ⑥ Screw M-SPAG into the sash. Note: It is recommended that the screw order is as follows:

- ① shootbolt end piece screws.
- ② either side of the lockcase.





Notes

A large rectangular area filled with a fine grid pattern, intended for taking notes.

**MACO
PROTECT**



MAYER & CO BESCHLÄGE GMBH
ALPENSTRASSE 173
A-5020 SALZBURG
TEL +43 (0)662 6196-0
FAX +43 (0)662 6196-1449
maco@maco.at
www.maco.at

**MACO DOOR & WINDOW
HARDWARE (U.K.) LTD**
CASTLE ROAD,
EUROLINK IND EST
SITTINGBOURNE, KENT
TEL +44 (0)1795 433900
FAX +44 (0)1795 433902
enquiry@macouk.net
www.macouk.net



Scan for more Info



Order.-N0. 756920EN - Date: December 2012
All rights reserved and subject to change.
Graphic source: MACO, shutterstock.com