



1. MACO concealed window valve

The concealed window valve is a reliable, durable and above all, largely maintenance free ventilation product. The air inlets automatically regulate the airflow into the interior. Flaps serve to limit the airflow depending on wind and weather conditions. This means fresh air is evenly distributed into the living space.

2. Product liability advice

- Your window is equipped with a concealed window valve. Operation is straightforward and trouble-free; nevertheless you should read and observe these instructions carefully.
- In your own interests; please do not forget to read the hazard and safety information (under point 5).
- Keep these operation and maintenance instructions safe in case they are needed and also inform other users of the contents of these instructions.
- Please observe the operating instructions and maintenance information in order to ensure that your concealed window valve works for many years to come.
- When used correctly, the ventilation product serves to prevent mould and moisture damage according to DIN 1946-6.

3. Functional areas in detail

	Suitable for fresh air supply and exit air		Wind and weather No draughts in windy
	Suitable for living rooms		Security The window remains closed
	Also suitable for use in bedrooms		Pests No access
	Ventilation during periods of absence Optimal minimum air exchange		Heat Controlled fresh air replenishment
	Humidity Moisture removal		

4. Interlocking mechanism

The valve can be locked by means of an actuating mechanism. Once the valve is locked, the minimum ventilation to prevent moisture damage is no longer ensured. Fresh air still flows in, but is kept to a minimum.

Permanently locking the ventilation flap can lead to a high increase in air moisture, thereby causing serious moisture damage.

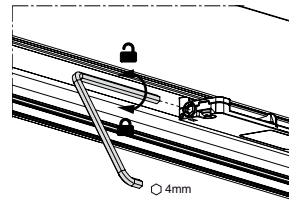

5. Hazard and safety information

5.1 Never seal up

Never seal the air inlet with adhesive tape or other means of covering. Doing so would cause the fresh air supply to be interrupted and thus lead to changes in the ambient air (increased moisture, bad odours or mildew and bacterial growth).

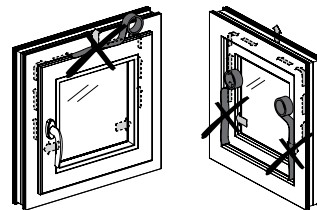

5.2 Never use aggressive cleaning agents

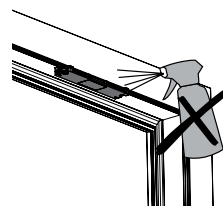

MACO VENTILATION

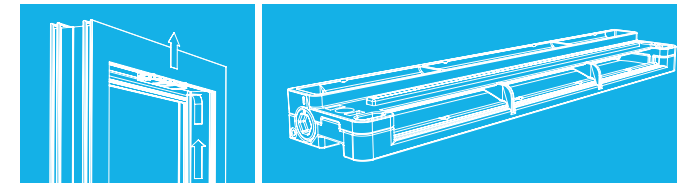

MACO concealed window valve
operating and maintenance
instructions

6. Operating and maintenance instructions

6.1 Open sash.

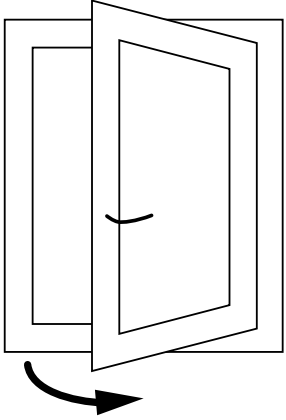

6.2 Clean MACO concealed window valve every three months using a cleaning cloth.

Fully remove moisture at least 1 x per month when using as a vertical transverse flow system.

Clean the window rebate and the air inlet area with a cleaning cloth.

Remove dust particles / water droplets.

Take care not to damage the PVC parts

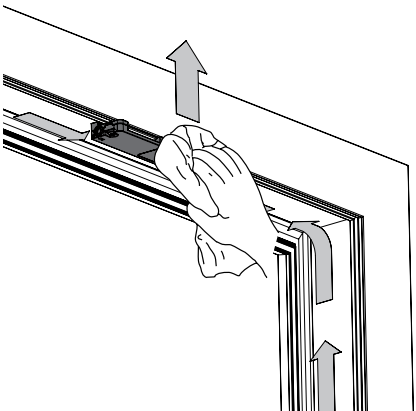

6.3 Clean air inlet area.

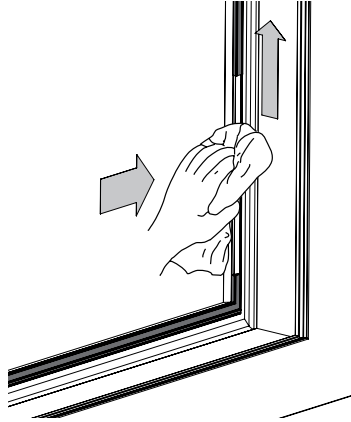

6.4 Clean window rebate area.

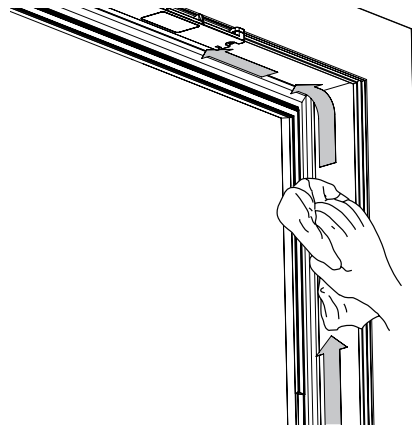

6.5 Close sash.

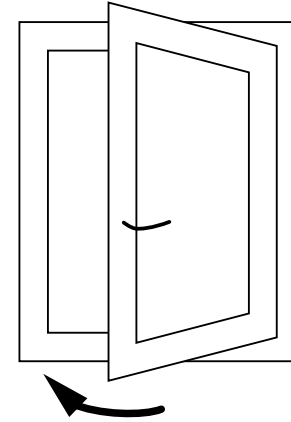

7. General advice for your room climate

- All window elements should serve for additional ventilation when you are present.
- Vertical transverse flow is the most effective window ventilation (5 – 10 min. per procedure).
- Each ventilation process serves to exchange the air in the room, however, excessive ventilation can lead to cooling of the walls, ceilings and floors (excessive energy loss).

8. Further information

Please scan the QR code to obtain further information about our products:



MAYER & CO BESCHLÄGE GMBH
ALPENSTRASSE 173
A-5020 SALZBURG
TEL +43 662 6196-0
FAX +43 662 6196-1449
E-Mail: maco@maco.at
www.maco.at

MACO DOOR & WINDOW
HARDWARE(U.K.) LTD
EUROLINK INDUSTRIAL
CENTRE CASTLE ROAD
SITTINGBOURNE KENT ME10 3LY
TEL +44 (0)1795 433900
FAX +44 (0)1795 433902
enquiry@macouk.net
www.macouk.net

Order no. 757052
Date: April 2014
All rights reserved
and subject to change